

### AREA 1 - Emergency & Registration

The Emergency Department is staffed 24/7 by Board-Certified Emergency Medicine Physicians from the University of Illinois Medical Center. Our community not only receives a higher level of medical care; but also, has a state-of-the-art environment designed to respond to the most critical, while using the latest medical advances.

The Emergency Entrance also serves as the 24-hour Patient Registration Center. Our Nursing Station offers a full view of all exam rooms, providing patients with optimal personal care. Other significant, life-saving features include Cardiac/Trauma Rooms. Soon, we will be equipped to provide Tele-Health, linking our physicians to top-specialists for patient consultation. The Ambulance Bays and Helipad are in the ideal proximity to the Emergency Department and Galena now has a sophisticated Decontamination Room.

### AREA 2 - Medical Imaging

Both the in-patient and out-patient Laboratory and Medical Imaging Departments are situated between our Emergency Department and Surgery Center. This expedites important patient tests and studies, offering efficiency for nurses and technologists and convenience for patients.

Our Imaging Department continues to offer the latest technology, including Computed Tomography (CT Scan), X-ray and Bone Densitometry Screening. In addition, we have added a Women's Imaging Suite, providing Ultrasound and Mammogram in a comfortable environment.

Also new to the hospital, is our highly advanced Magnetic Resonance Imaging (MRI) capabilities. MRI is used to detect tumors, bleeding, injury, blood vessel problems, or infection.

### AREA 3 - Surgery

With two state-of-the-art surgical suites complete with high-level booms, monitors, and laparoscopic equipment, we have the capability to offer convenient same-day surgery.

### AREA 4 - In-Patient Care

Our in-patient care design, like that of the entire medical center, offers the best in healthcare, integrated with the finest hospitality has to offer. We are 100% patient focused. Our Nursing Stations are centrally located so that each patient suite is just steps away. All of the spacious, patient suites have a lovely view with beautiful décor and private baths, all optimal in a healing environment.

On this floor you will find a special family kitchen, dining area and comfortable guest lounge. We believe in taking care of the family as much as we do the patient.

### AREA 5 - Meditation

Traditionally, hospitals have either a sanctuary or chapel. Our Meditation Room offers patients and their families, a quiet place to reflect in an environment that is open to people of all faiths.

### AREA 6 - In-Patient Pharmacy

We are pleased to offer an In-patient Pharmacy that provides physicians, nurses and patients medicine and consultation services.

### AREA 7 - Midwest Health Clinic

The Medical Office Building is home to Midwest Health Clinic, our first hospital based physician, nurse practitioner and rural medicine teaching practice. We will continue broadening our physician base to include specialists in a variety of areas. A spacious reception and waiting area, as well as large exam and procedure rooms, offers efficiency for the practice, comfort and convenience for patients.

### AREA 8 - Sleep Center

The Midwest Medical Sleep Center is led by a dynamic team of specialists and is equipped with the latest diagnostic technology.

### AREA 9 - Whispering Willow Gifts

Whispering Willow Gifts is not your average hospital gift shop. You will find sundries, unique gifts, snacks and much more. The shop is operated by our dedicated Auxiliary.

### AREA 10 - Resource Library

Midwest Medical Center is more than the place where our community members can come for advanced medical care. Our Resource Library strives to be a place where information on prevention and health and wellness can be found.

### AREA 11 - Physical Rehabilitation & Fitness

When you first walk through the entrance of the Midwest Health & Fitness Center and Physical Therapy Department, you will notice the beautiful view seen through the windows that surround the center. With private men's and women's dressing lounges, a large work-out area, complete with fitness and rehab equipment, a modern exercise studio, private exam rooms, including a massage therapy suite, this area offers patients and the entire community an outstanding environment for health and wellness.

### AREA 12 - Physician's Lounge

It is important that our staff and visiting physicians have a place where they can work, rest and consult in comfort and privacy.

### AREA 13 - Medical Records

It is essential that medical records are kept where they are secure and accessible to physicians. Our Medical Records department is also designed to accommodate our transition to electronic records.

### AREA 14 - Vista Café

Located just off of the main reception and guest area, the Vista Café is a gathering place to enjoy healthy, delicious meals and snacks. With indoor and outdoor seating, it overlooks the rolling fields of Galena and is just steps away from our Healing Garden.

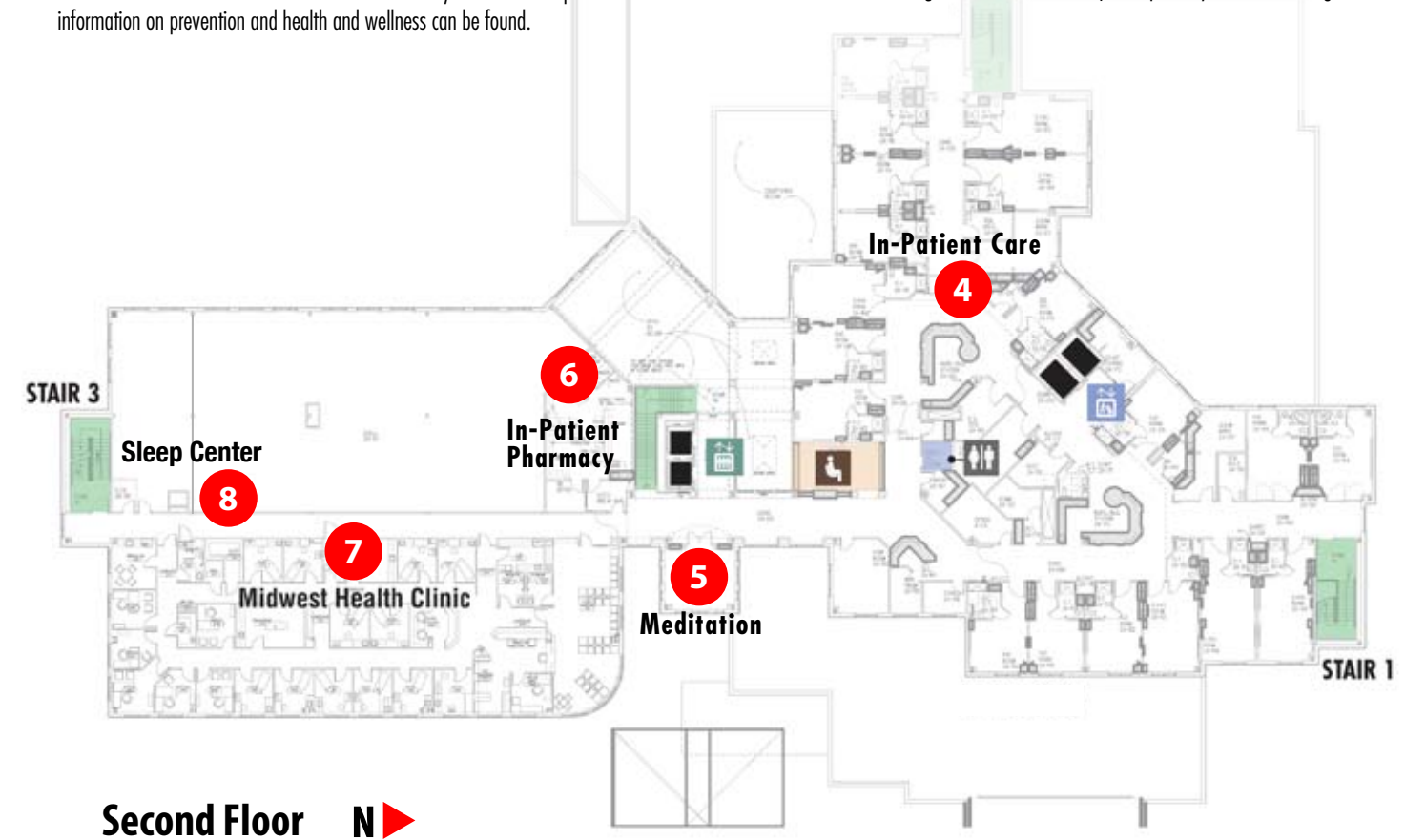
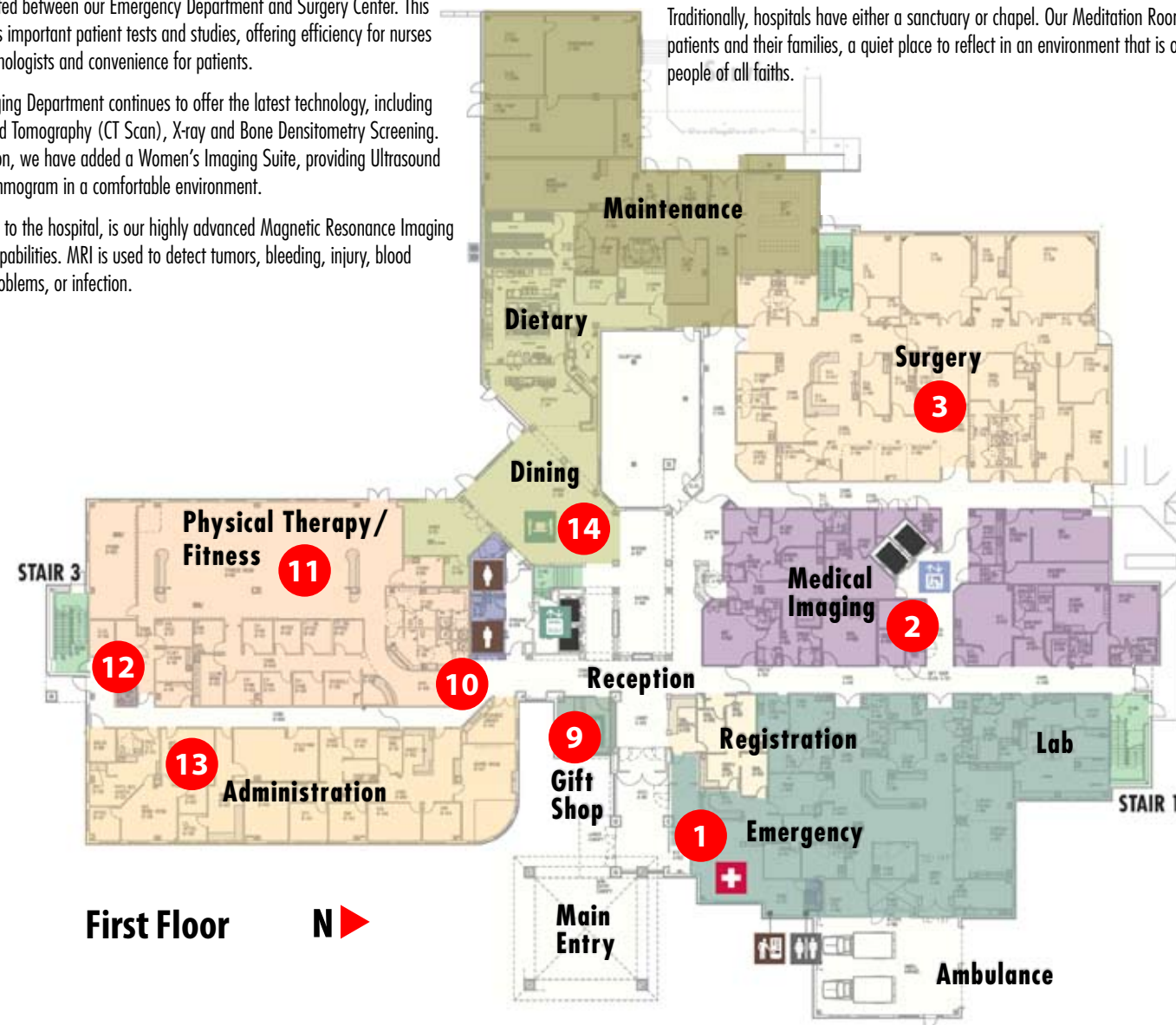

No food or beverage items are allowed in the tour areas. In order to make the tour enjoyable for everyone, we ask that you remain with your designated group and follow the prepared tour directions. Thank you.